

Step 1:

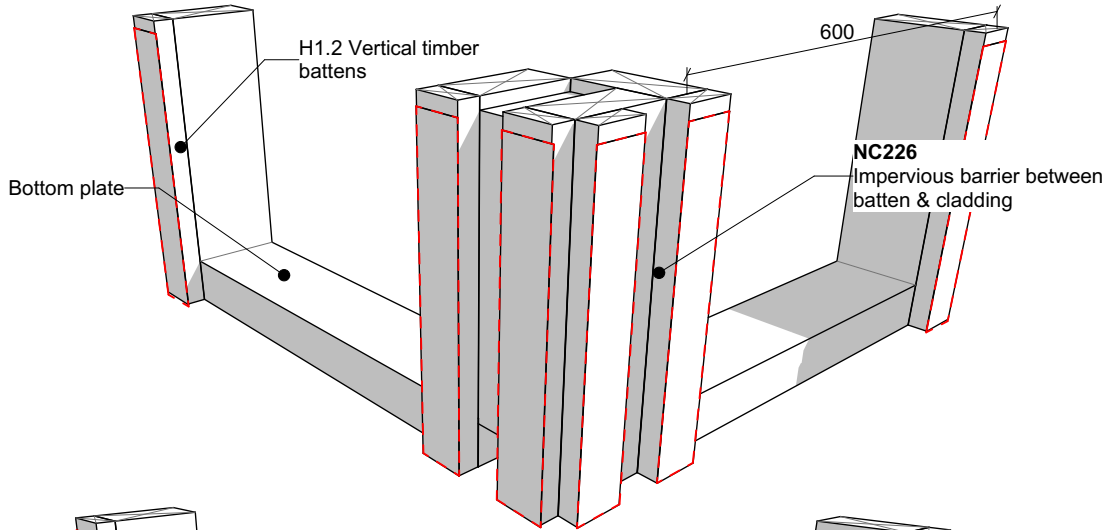

Step 2:

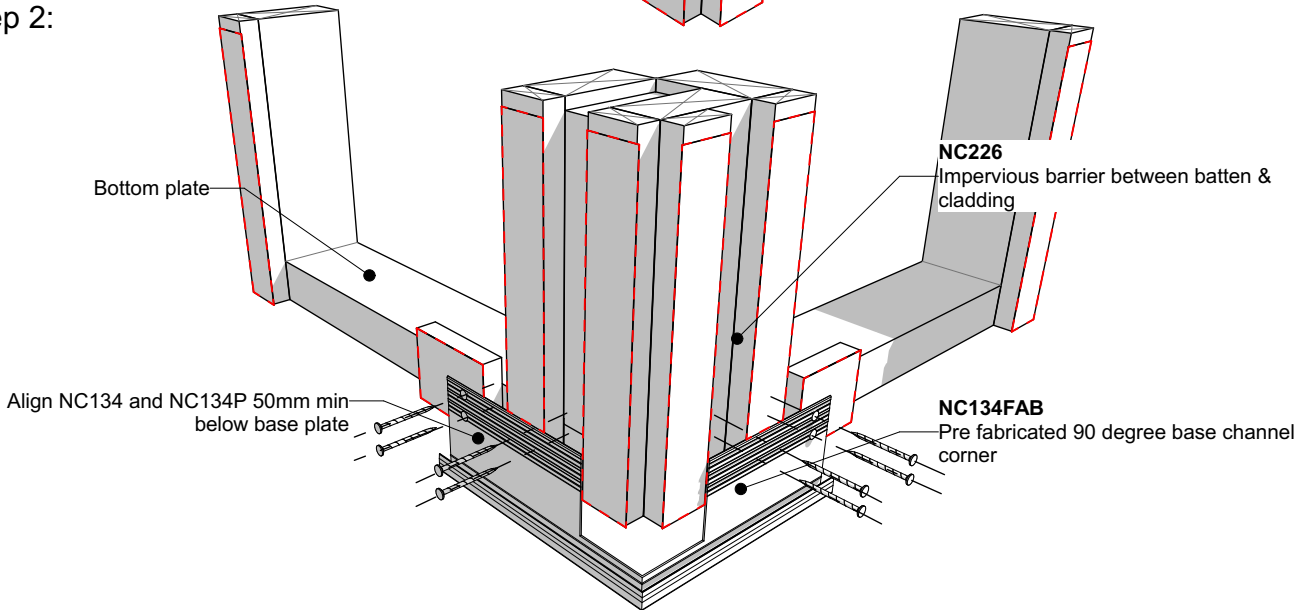

Step 3:

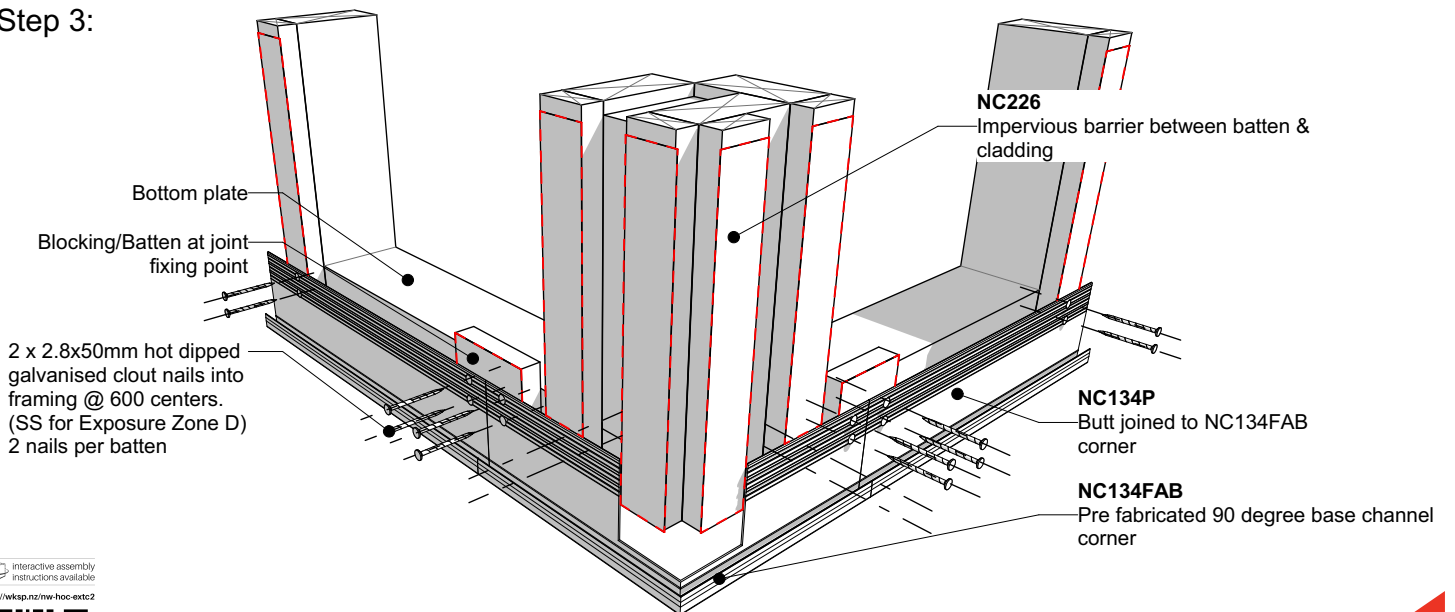

Interactive assembly instructions available
<http://wvsp.nz/nw-hoc-extc2>



Get WORKINGSPEC from
 Apple App Store/Google Play



BRANZ Appraised
 Appraisal No. 556 [2019]

Nu-Wall cladding horizontal on cavity
 Pre-Fabricated 90 deg base channel corner

NW-HOC-008.01

Drawn by: Nu-Wall Date: 3/04/2022

Checked by: RL, GT Scale: NTS

© 2021 copyright in this document is the property of Nu-Wall Aluminium Cladding Limited. All rights reserved. Nu-Wall is a registered trademark of Aluminium Product Brands NZ Limited