

Custom folded 1.2mm aluminium flashing powder coated to match cladding and chased in to 15x6mm saw cut and sealed with flexible joint sealant (By others)

Crushed

**NC138 + NC139**  
Termination flashing base and cap.

**NC 204**  
10g x 16mm csk Tek screw @ 600 centers through anti-crush buttons

**NC 220**  
15x15mm closed-cell foam insert

Concrete masonry block wall

Cut / ripped board

**NC204**  
10g ss csk screws with 30mm min embedment

**NC203E**  
fixing clip @ 600 centers

Direction of installation ↑

30min

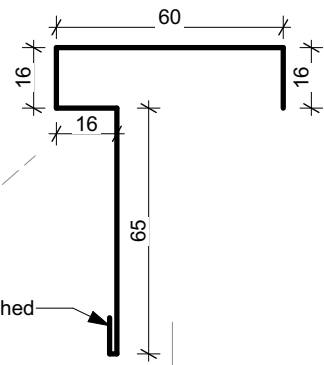

**General note:**

- Cladding fixings omitted for clarity
- When finishing a wall with a ripped board, the board must be direct fixed with a counter sunk screw @ 600mm centres



Nu-Wall cladding vertical direct fix  
Typical Nu-Wall to concrete masonry external corner

NW-VDF-032.01

Drawn by: Nu-Wall	Date: 9/05/2022
Checked by: RL, GT	Scale: 1:2 @ A4

© 2021 copyright in this document is the property of Nu-Wall Aluminium Cladding Limited. All rights reserved. Nu-Wall is a registered trademark of Aluminium Product Brands NZ Limited