

NC227

Plastic soaker flashing behind jamb.
Flashing base extends down in to
base channel or into a horizontal
joint

See notes for correct setting
out position of windows

8 - 10mm cover

NC246

Neoprene sealant tape

NC248

Jamb flashing cap

NC247

Jamb flashing base.

Leave 6mm gap between sill
batten. Sill batten to be max.
length 500mm

NC226

Impervious barrier between
batten & cladding

Wall underlay

Drained and vented cavity as
per E2/AS1

Flashing tape
(by others)

Packer as required

Air seal

Aluminium window support bar

Single castellated timber batten.
Notched as required at sill support bar.
*See note

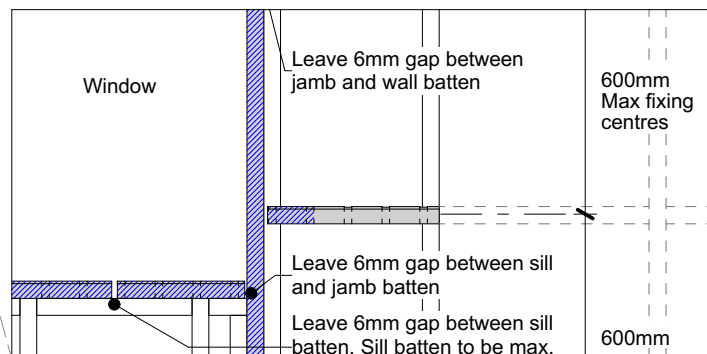
**General note:**

- Cladding fixings omitted for clarity

Window setting out notes: (from face of cavity batten)

- 17-18mm for hollow fin windows
- 18-20mm for solid fin windows

Cavity batten note:

- 20mm single castellated timber battens required for all Nu-Wall installations.
- Batten to have 15° slope for moisture egress
- Allow 6mm gap between vertical and horizontal battens
- Sill and head battens to be max. 500mm with a 6mm gap to each segment
- 18mm single castellated battens are available from Nu Wall for all vertical applications to wall junctions and jambs
- Proprietary Nu-Wall Alibat is available as an alternative when a structural non-combustable cavity batten is required

Interactive assembly
instructions available
<http://wksp.nz/nw-voc-win>



Get WORKINGSPEC from
Apple App Store/Google Play



nu-wall
CLADDING

Nu-Wall cladding vertical on cavity

Typical sill section - NC247 and NC248 assembly

© 2021 copyright in this document is the property of Nu-Wall Aluminium Cladding Limited. All rights reserved. Nu-Wall is a registered trademark of Aluminium Product Brands NZ Limited

NW-VOC-016.02

Drawn by: Nu-Wall

Date: 02/07/2025

Checked by: RL, GT

Scale: 1:2 @ A4